



# **BATEL**

## **ELEKTROMEKANİK**

**BNA**

**SF<sub>6</sub> GAS INSULATED DISCONNECTOR**

**UP TO 40.5 kV**

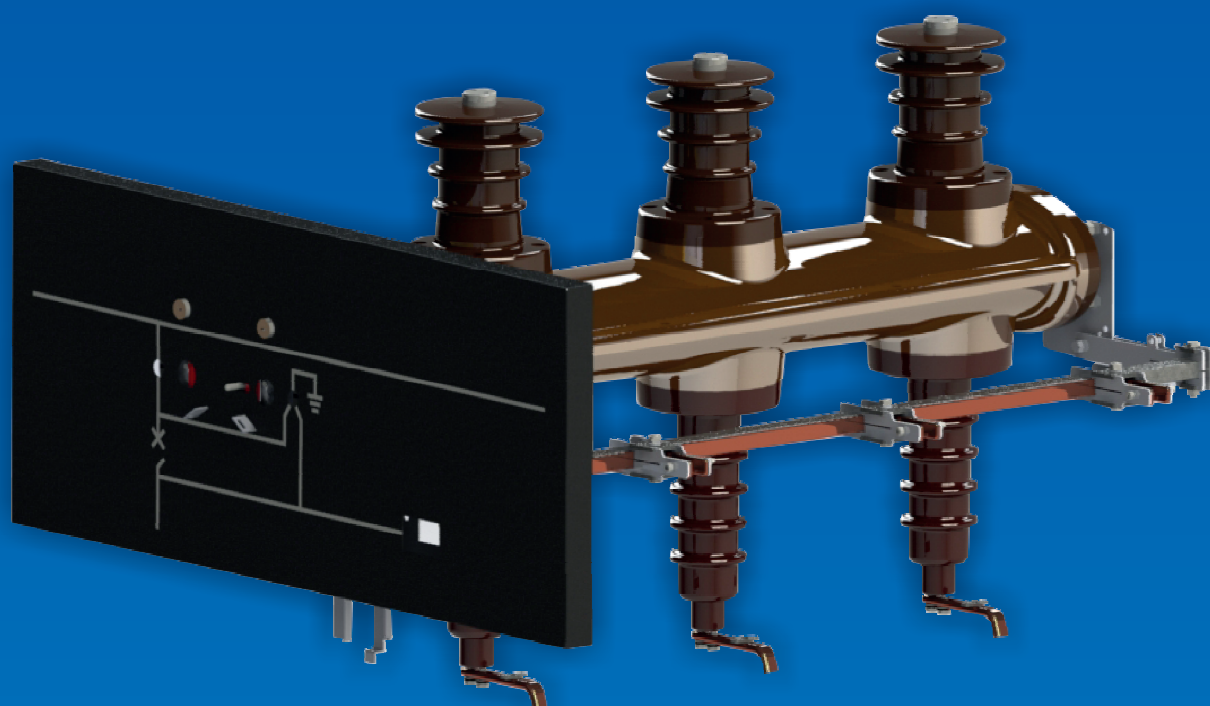

# SF6 GAS INSULATED DISCONNECTOR



## General Specifications

The main contacts of the disconnecter are in the epoxy resin enclosure which is filled with 1.5 bar SF6 gas and this sealed pressure system guaranteed for its life.

The disconnecter contacts can be in one of the two positions; closed / open.

The earthing switch is outside of the enclosure, and its position clearly and safely can be observed directly. Its operation is interlocked with the mechanism of the main contacts.

The safety of the gas filled enclosure is secured by the membrane system positioned at back side.

Auxiliary contacts indicating the position of the main contacts and for the earthing switch are present.

Key type interlocks are possible.

| TECHNICAL SPECIFICATIONS                                      |                               | 12 kV                         | 24 kV | 38/40.5 kV |
|---|-------------------------------|-------------------------------|-------|------------|
| Rated voltage, kV   |                               | 12                            | 24    | 38/40.5    |
| Rated power-frequency withstand voltage 50Hz 1Min (kV r.m.s.) | To earth and between phases   | 28                            | 50    | 95         |
|   | Across the isolating distance | 32                            | 60    | 105        |
| Rated lightning impulse withstand voltage (peak value)        | To earth and between phases   | 75                            | 125   | 200        |
|   | Across the isolating distance | 85                            | 145   | 220        |
| Rated current, A  |                               | 630/1250                      |       |            |
| Short time withstand current, 1s, kA                          |                               | 16/20/25                      |       |            |
| Related Standard  |                               | IEC 62271-102                 |       |            |
| Mechanical endurance class                                    |                               | M2 ( 2000 operations)         |       |            |
| Ambient temperature for working                               |                               | - 5 / + 40                    |       |            |
| Release coil and charging motor options : Power supply        |                               | 24V/48V/110V/220V DC, 220V AC |       |            |

# SF6 GAS INSULATED DISCONNECTOR

## 12-24 kV 630A DISCONNECTOR SWITCH

Top view

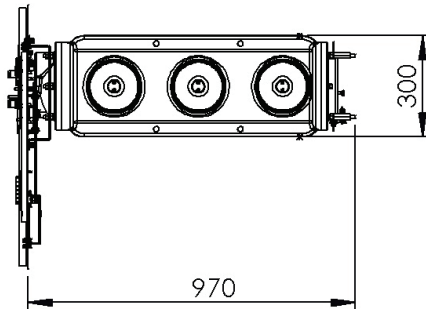

Side view

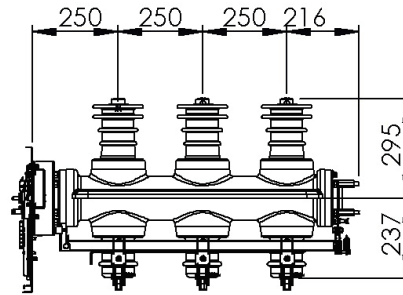

Front view

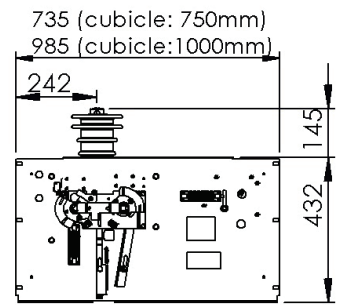

## 38/40.5 kV 630A DISCONNECTOR SWITCH (width: 750mm)

Top view

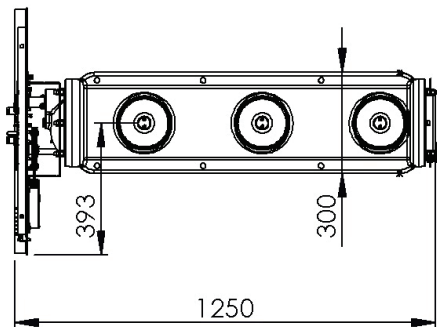

Side view

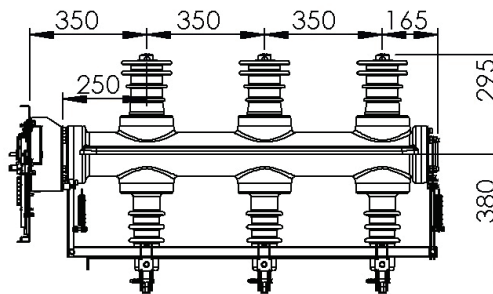

Front view

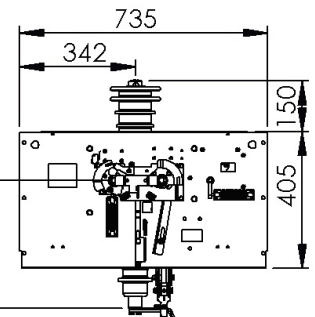

## 38/40.5 kV 630A DISCONNECTOR SWITCH (width: 1000mm)

Top view

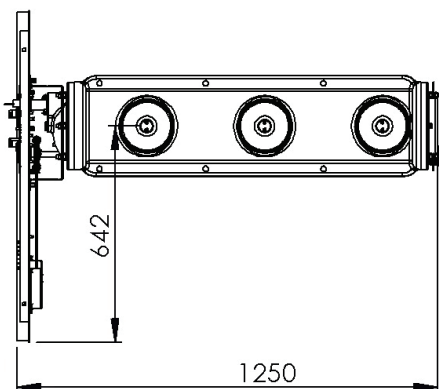

Side view

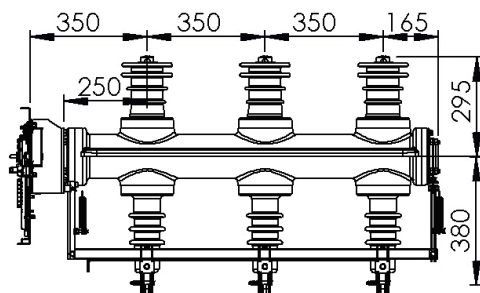

Front view

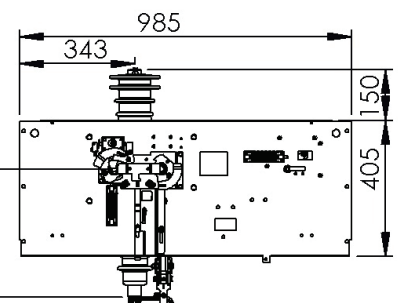

# QUALITY MANAGEMENT



**BATEL ELEKTROMEKANIK SAN. ve TIC. AS.**  
**IAOSB 10001 Street No:13 Cigli / IZMIR - TURKEY**  
**Tel: +90 232 376 76 90(pbx) Fax: +90 232 376 76 91**  
**www.batel.com.tr e-mail: info@batel.com.tr**